

# MR01

## SQUARE DOUBLE RAIL

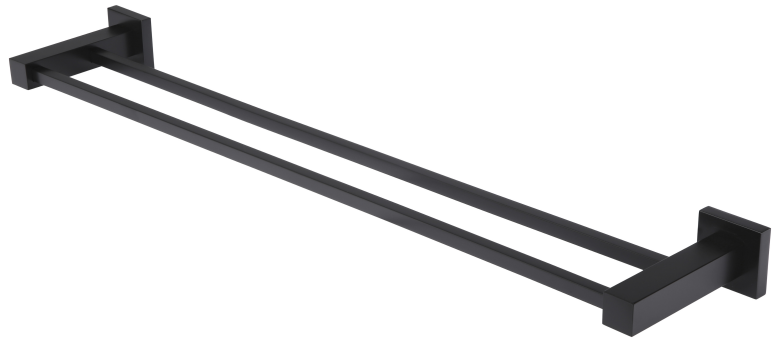

meir®

MATTE BLACK  
MR01

CHROME  
MR01-C

AVAILABLE  
FINISHES

### EXPLODED VIEW

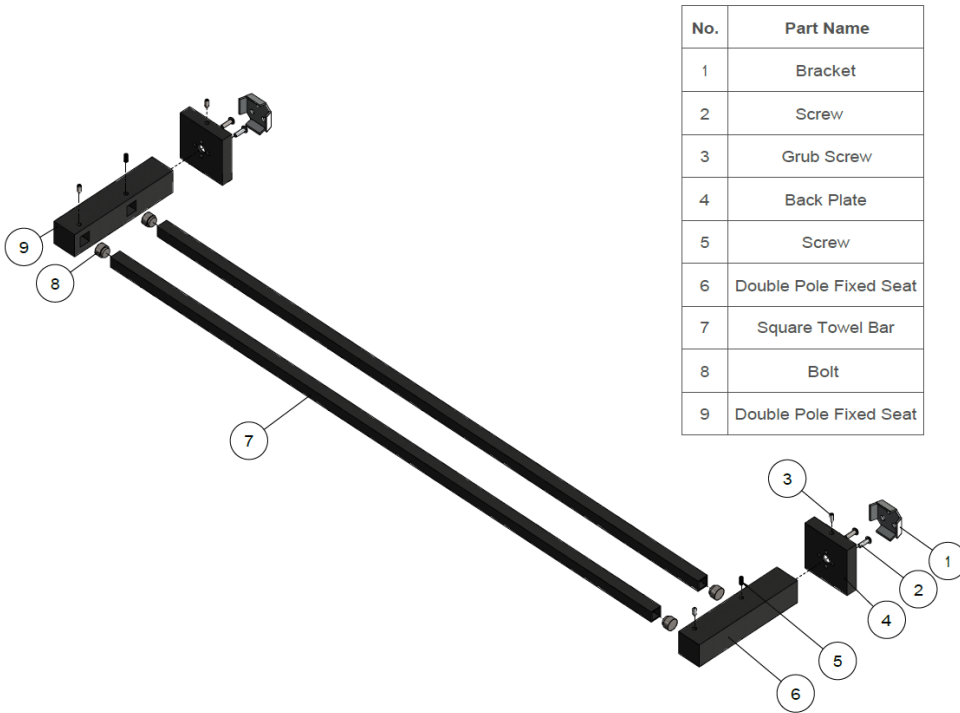

No.	Part Name
1	Bracket
2	Screw
3	Grub Screw
4	Back Plate
5	Screw
6	Double Pole Fixed Seat
7	Square Towel Bar
8	Bolt
9	Double Pole Fixed Seat

### CARE

- Do not install tapware using any form of acetone silicones.
- Do not apply physical items (such as tools) directly to product.
- Never use house-hold or commercial detergents, citrus based cleaners, or abrasive cleaners.
- Clean using a mild washing soap solution rinsed, and dry with a soft cloth.
- Check for any product defects before installation.
- Refer to the installation manual for correct installation.

### FEATURES

- 10 Year warranty
- Solid brass construction
- Box Weight 1.2Kg

### SPECIFICATIONS

